

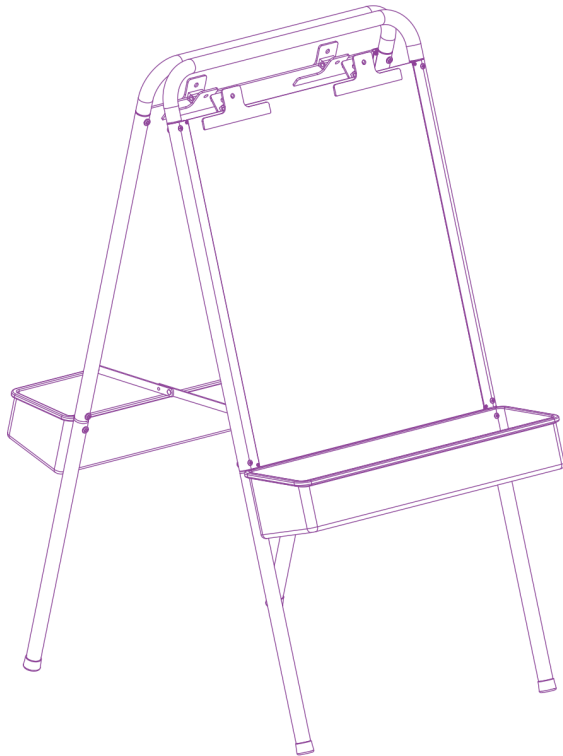

# ASSEMBLY INSTRUCTIONS

## 2-Way Acrylic Easel



**Directions:** Use as indoor or outdoor easel. Attach paper to clips or paint directly onto acrylic panels. For best results, use easel outdoors or close to a windows so that light can shine through paint. Allow 2 children to use the easel at the same time and encourage them to paint the images of each other.

**Note:** Some paints may flake off when dry. Do not use permanent marker or glass paint on acrylic panels. Trays have small holes the bottom for draining.

**To clean:** If outdoors, spray with garden hose. If indoors, spray decorated acrylic panels with warm water and let soak. Multiple sprayings may be necessary. Wipe clean with soft cloth or paper towel. For tough paint spots, spray panels with a solution of warm water and dishwashing liquid. Avoid scraping acrylic panels with metal or wire brushes.

A	1PC		H	8PCS	
B	2PCS		I	1PC	
C	4PCS		J	1PC	
D	2PCS				
E	4PCS				
F	8PCS				
G	8PCS				

**CAUTION**  
Adult assembly required due to the presence of small parts, sharp edges, and / or sharp points.

# ASSEMBLY INSTRUCTIONS



## Step 1: Attach Acrylic Panels(B) to Frame

Insert the acrylic panels (B) into the frame tube (A) slot.

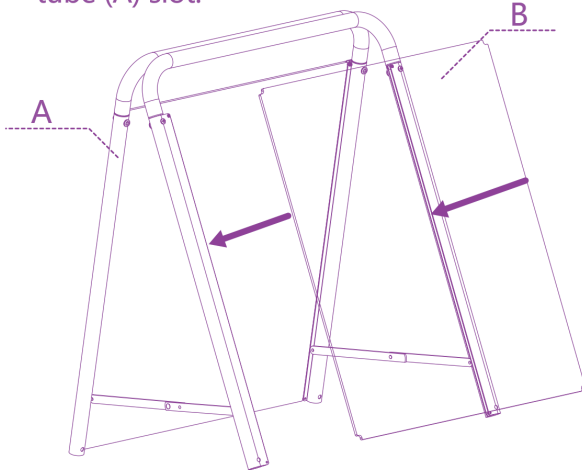

## Step 3: Attach Paint Trays (D) to Frame

Line up the hole of tray "D" with lower hole of leg tube. Push screw holder "G" through back of frame, attach with washer(H) and screws "F". Fixing the screw tightly by screw-driver(J) and Allen key (I).

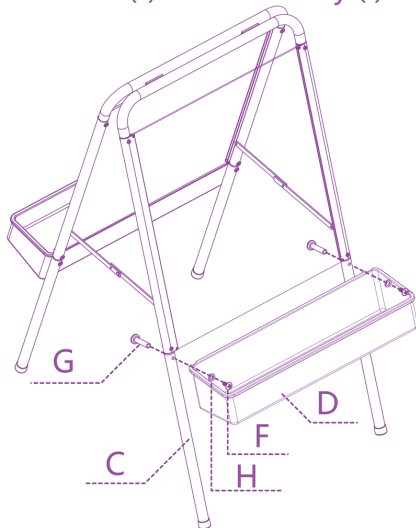

### ⚠ CAUTION

Adult assembly required due to the presence of small parts, sharp edges, and / or sharp points.

## Step 2: Attach Legs(C)

Assemble Frame by adding legs "C" to frame "A". Line up upper hole of leg tube with hole of frame. Connect the two parts by using screw holder "G", washer "H" and screw "F". Fixing the screw tightly by screw-driver(J) and Allen key (I). Once complete, stand frame upright on legs.

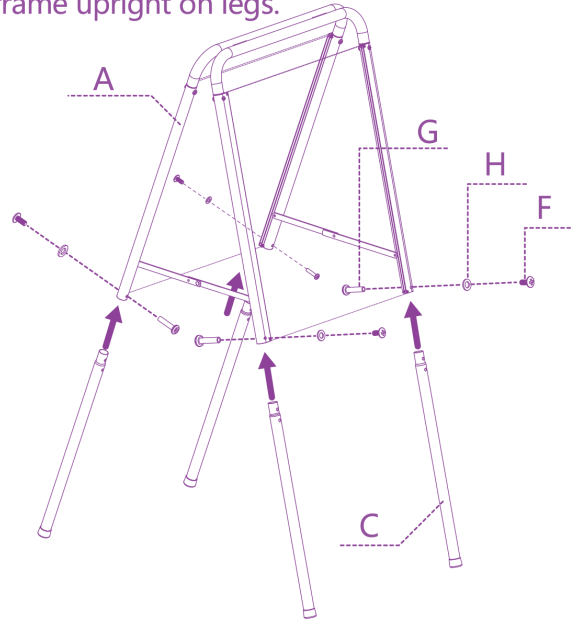

## Step 4: Peel off Protective Film and Attach paper clip (E)

Peel off transparent protective film from acrylic panels. If transparent film is hard to remove, try warming adhesive with a hair dryer first. Attach 4 PCS paper clips on each acrylic panel. The whole assembly is finished.

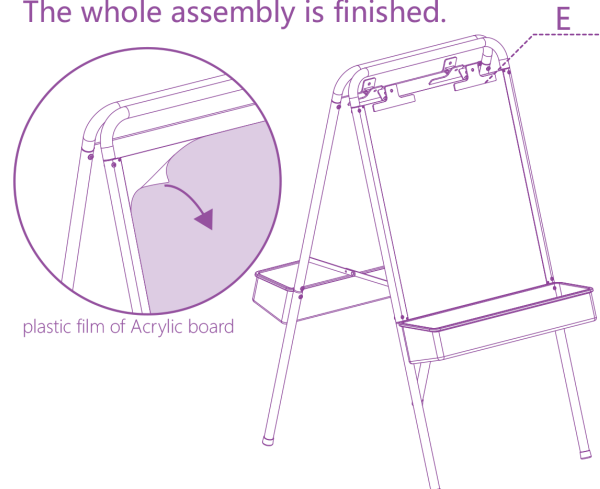

plastic film of Acrylic board